



Gather

A MOVEMENT IN



OCTOBER 2021

CAPITAL CAMPAIGN UPDATE

Inspiring students to love beauty,
think deeply, and pursue Christ's calling.



Front of Lower School Rendering

Our movement began nearly three decades ago when friends gathered to discuss the state of education in America and how they might transform it. They sowed the seeds that planted this Christian classical education that seeks to challenge and inspire both the bodies and souls of its students.

The Geneva School will always seek to be a place where scholarship and Christian character thrive: a community that brings glory to God and good to neighbor. In order to fulfill the mission with excellence, we desire a permanent campus with facilities that match the quality of education we provide and allow more students the opportunity to experience a Christian classical education.

Our Movement in G Campaign started with Phase I in November 2016 when we built a state-of-the-art athletic complex. In August 2019, Phase II was crowned with the completion of our upper school (7th–12th) and administrative building, now lovingly named Ingram Hall after retired headmaster and founder Robert Ingram and his wife, Marjean, for their unwavering service and financial commitment to Geneva.

In 2020, a small group of donors launched Phase III, the Gather Campaign, with a generous donation of \$8.5MM in order to bring our community back together on one campus with a new lower school and a competition gymnasium.

Last year, the Geneva community gathered an additional \$3.2MM in gifts toward the project, excited about the prospect of being on one campus again. Although there is still nearly \$500K left to raise to complete the cost for the lower school building, the board voted to move forward with the lower school but hold off on the competition gym until more funding had been committed.

The summer of 2021 brought hot weather, construction trailers, and earth movers as Clancy & Theys, the general contractor, prepared to break ground for the project. The lower school building will sit adjacent to Ingram Hall and the athletic complex, which sit on 40+ acres of property in Casselberry, FL.

The plan to accommodate the additional athletic practices and competitions was to rent a nearby gymnasium as we continued to raise the funding needed to build the second gymnasium.

Aerial View of Upper School and Competition Gymnasium Rendering



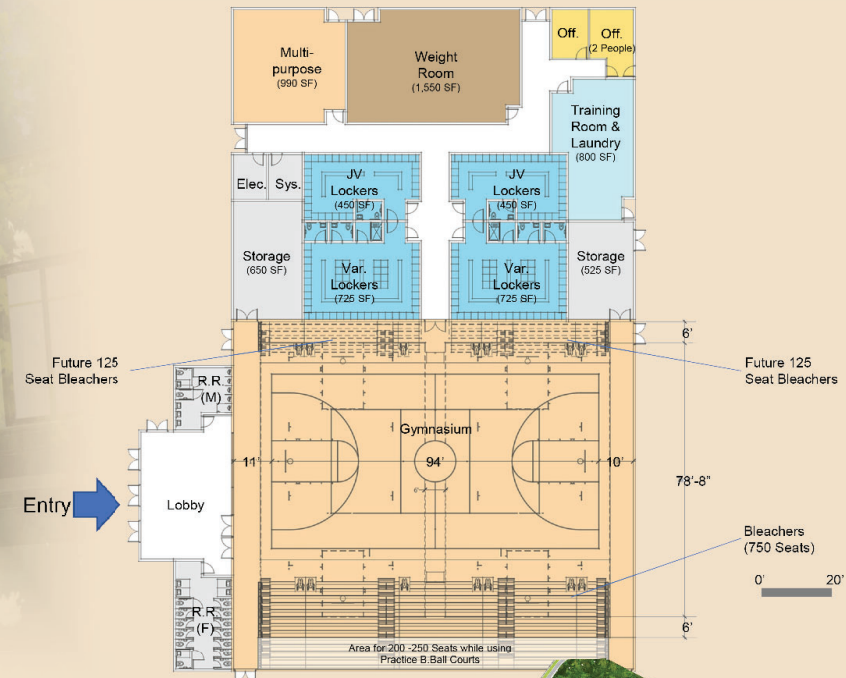

September arrived with a grand surprise; a small group of generous donors committed \$5MM to build the competition gymnasium ... NOW!

The cost to build will be significantly lower by moving forward now because construction crews are already mobilized and construction costs are projected to increase. This infusion of momentum will help complete the Gather Campaign (\$500K needed) and allow the school to break ground on the competition gymnasium. The board determined that we will build that which we can afford according to the amount of committed funds. We need an additional \$2.5MM to finish the entire scope of the project.

Case for the competition gymnasium:

The Geneva School is a Christian classical school committed to teaching foundational knowledge and analytic thinking through a biblical worldview. Ultimately, we desire to shape our curriculum and programs so that our graduates grow into confident and winsome communicators in both written and spoken words who desire to use all of their gifts and wisdom to influence the culture for God's glory and the expansion of his kingdom. Every day, we make arguments for or against something; very little, if anything, in life is neutral.



So why do we want to build a competition gym?

Its very existence makes an argument; its architecture makes an argument. Architecture, like music and art, conveys ideas, emotions, and experiences. However, architecture cannot be closed in a book or turned off—it remains. Once the building exists until the day it is razed, it communicates a message. We trust that the message that this building conveys to our whole community is that of excellence, joy, exuberance, encouragement, competition, perseverance, gathering, and growth.

This gym will serve as a battleground for wins and losses and as a place where Christian character is tested and grows in the face of challenges. This gym will provide a space where students can learn to, in the words of Isaiah, “run and not be faint.” Or in the words of Paul, “lay aside every weight, and sin which clings so closely, and ... run with endurance the race that is set before [them].” This gym will allow experiences to happen that will sharpen students’ skills for battle—in athletics and in life. This gym will provide times where the whole community can demonstrate love for your neighbor and the fruit of the spirit as we interact with teammates, officials, opposing teams, and coaches. This gym will encourage the pursuit of excellence in both talent and character. As we have said during our earlier campaigns, and we trust remains true: we shape our buildings, and thereafter, they shape us. Stories that are written in this space of battles ending in both defeat and victory will be the stories describing who we are; these will be told by students and parents alike to each other and to their children one day. I pray that all of these stories depict a pursuit of excellence and a grateful acknowledgment of giving all praise and honor due him who has given us this place.

Competition Gym Rendering



1	LOWER SCHOOL (including LS parking lot)	\$15.5M
	54,000+ square feet that includes 27 K4–6th grade classrooms, library, art rooms, music rooms, science rooms, a da Vinci room, offices, covered outdoor dining, playgrounds, and small study spaces	
2	VARSITY COMPETITION GYMNASIUM	\$7M
	30,000-square-foot gym that holds 1,200 people (all-school events and attendance for state tournaments), expanded weight room, training room for physical therapy, storage, JV and varsity locker rooms complete with shower facilities	
3	ENTRANCE AND CIRCLE DRIVE	\$600K
	Extend the road into the site to allow more cars off of Seminola Boulevard, soften the turns into and out of the parking lot/drop-off lanes, reduce the size of the grass circle, add a water element for aesthetics, and add more landscaping	
4	EXTEND UPPER SCHOOL DROP-OFF LOOP	\$100K
	Double the length of the drop-off road to accommodate the additional cars entering and exiting the campus safely	
5	ATHLETIC PARKING LOT	\$120K
	A school always needs more parking	
6	CONCESSION STAND EXPANSION	\$330K
	Expand the concession building to provide more athletic storage and a canopied area, including fans for spectators and athletes during heat or inclement weather	
TOTAL		\$23.7M



Circle Drive Rendering

From a practical standpoint, as we plan for thoughtful and intentional growth in enrollment, we can look to industry best practices to help us evaluate the need for a competition gym as well.

ISM, Independent Schools Management, a research-based, data-driven organization that has been tracking and analyzing trends in the private school sector for over thirty years, has strong words of encouragement for building not just a gym but a competition gym. Data shows that the number one thing that attracts a high school student (athlete and non-athlete) is the opportunity to engage in “adult-like” activities centered around performance. Sports remain the number one “adult-type” activity that high school students desire, and a competition gym (complete with amenities) is the number one symbol of a school that takes seriously the students’ opportunity to engage in sports at a high level of competition.

The competition gym will foster school pride, develop a community around which the students and parents will rally, and provide adequate space for the needs of our growing community. The additional spaces will include multiple locker rooms, a larger weight room, a training room and laundry facilities, and offices. The demands on our two current gym spaces are already significant given the number of PE classes, youth sports, and upper school sports—and these demands will only increase as the student body grows. If we moved to the new campus and only had one gym, we planned to lease a gym nearby as a temporary measure since it would not satisfy the needs of the school long-term. This new competition gym will provide a much needed space where all of our students and staff can meet together for various events, including events like convocation and all-school assemblies, serving to enhance the Geneva community’s experience for years to come.

YOUR Giving POTENTIAL

Join us in the *Gather Campaign* today. Please email Katie Deatherage at kideatherage@genevaschool.org or visit genevaschool.org/gather-campaign to make your pledge.

MONTHLY (\$)	ANNUALLY (\$)	3-YEAR TOTAL
\$100	\$1,200	\$3,600
\$250	\$3,000	\$9,000
\$500	\$6,000	\$18,000
\$1,000	\$12,000	\$36,000
\$2,000	\$24,000	\$72,000
\$3,000	\$36,000	\$108,000

LUMP SUM GIFT	QUARTERLY GIFT	MONTHLY GIFT
Maybe you are able to make a one-time gift now. There are many ways to give to this capital campaign!	Maybe for your financial situation it is easier to plan on a quarterly basis. There is flexibility in how pledge payments can be made, so think about the payment schedule that works best for you.	Not ready to commit to a 3-year pledge, but feel confident you can commit to 12 months, or 18 months? There is flexibility in the pledge schedule. We are thankful for your generosity.

Lower School Rendering

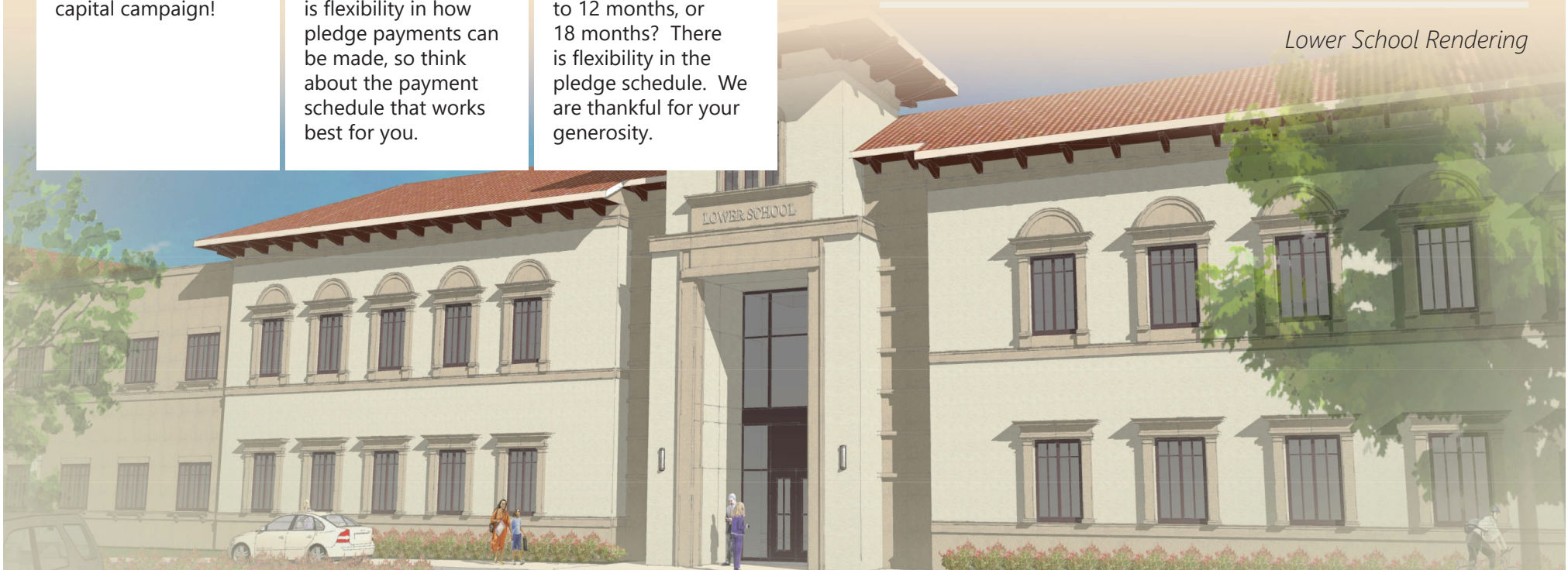

BUILDING A MASTERPIECE. LEAVING A LEGACY. GATHERING TOGETHER



The Geneva School
2025 State Road 436
Winter Park, FL 32792



**BUILDING A MASTERPIECE.
LEAVING A LEGACY.
GATHERING TOGETHER**